

MC SERIES CONNECTOR



CPC's MC Series chrome-plated brass couplings are built tough and made to last in the most demanding applications. Ideal for use with higher temperatures or pressures, MC Series couplings feature one-hand operation for swift and easy connects and disconnects. These couplings offer the flexibility of multiple configurations and terminations and mate with both PMC acetal and PMC12 polypropylene couplings.

Specifications ● ● ●

PRESSURE:

Vacuum to 250 psi, 17.3 bar

TEMPERATURE:

-40°F to 180°F (-40°C to 82°C)
(High temperature versions available with ratings to 400°F)

MATERIALS:

Main components:

Chrome-plated brass

Thumb latch: Stainless steel

Valves: Acetal

Valve spring: 316 stainless steel

External springs and pin: Stainless steel

O-rings: Buna-N

FINISH:

Chrome

TUBING SIZES:

1/8" to 1/4" ID, 3.2mm to 6.4mm ID

WARNING: Pressure, temperature, chemicals, and operating environment can affect the performance of couplings. It is the customer's responsibility to test the suitability of CPC products in their own application conditions. Use the graph to the right as a guide.

FEATURES

Brass material

CPC thumb latch

Compatible

BENEFITS

Durable and able to withstand higher pressure and temperature

One-hand connection and disconnection

MC mates with PMC and PMC12 Series couplings

MC Air Flow, 100 psig Inlet Pressure

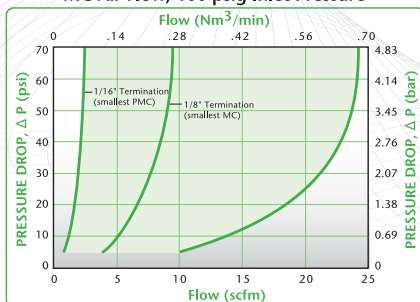

MC Water Flow

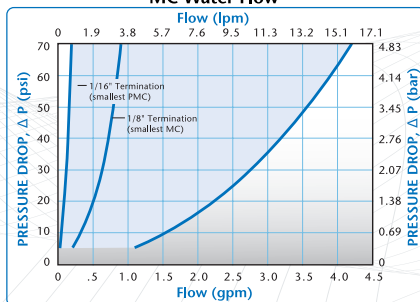

« These graphs are intended to give you a general idea of the performance capabilities of each product line. The shaded area of each graph represents the operating range of the product family, i.e., upper and lower values are shown. Therefore, depending on the exact coupling configurations selected, you can reasonably expect values to fall within the shaded area.

MC DIMENSIONS

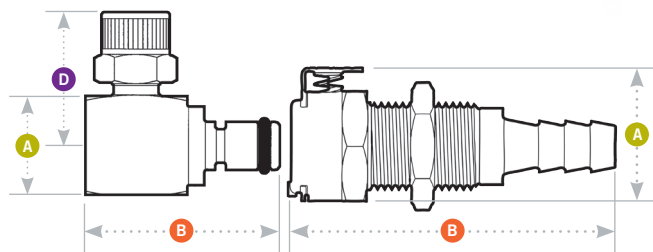

- A** = Height/Diameter
B = Total Length
D = Elbow Radial Length

Panel Dimensions

	PANEL OPENING	PANEL THICKNESS MAX.-MIN.	PANEL NUT HEX	PANEL NUT THREAD
COUPLING BODIES (except male thread)	see drawing	.50 – .05	5/8	1/2-24UNS
MALE THREAD	see drawing	.21 – .06	5/8	1/2-24UNS
COUPLING INSERTS	see drawing	.30 – .06	5/8	1/2-24UNS

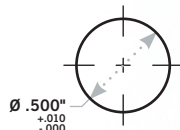

Coupling Bodies • CHROME-PLATED BRASS



TERMINATION IN-LINE PIPE THREAD

TUBING/THREAD SIZE METRIC EQ.

NSF PN

STANDARD PN

A

B

1/8" NPT		15200	MC1002 NSF	.76	1.00
1/8" NPT		15500	MCD1002 NSF	.76	1.00
1/4" NPT		15800	MC1004 NSF	.76	1.10
1/4" NPT		15900	MCD1004 NSF	.76	1.10
1/4" OD, .17" ID	6.4mm OD, 4.3mm ID	16800	MC1304 NSF	.76	1.77
1/4" OD, .17" ID	6.4mm OD, 4.3mm ID	16900	MCD1304 NSF	.76	1.77
1/8" ID	3.2mm ID	17100	MCD1702 NSF	.76	1.67
1/4" ID	6.4mm ID	17200	MCD1704 NSF	.76	1.89

IN-LINE FERRULELESS POLYTUBE FITTING, PTF†

IN-LINE HOSE BARB

Coupling Inserts • CHROME-PLATED BRASS



TERMINATION IN-LINE PIPE THREAD

TUBING/THREAD SIZE METRIC EQ.

NSF PN

STANDARD PN

A

B

D

1/8" NPT		17300	MC2402 NSF	.58	1.03	
1/8" NPT		17400	MCD2402 NSF	.58	1.43	
1/4" NPT		18000	MCD2404 NSF	.65	1.43	
1/8" NPT Female		17500	MC2602 NSF	.58	.95	
1/4" NPT Female		18200	MCD2604 NSF	.72	1.82	
1/4" OD, .17" ID	6.4mm OD, 4.3mm ID	18600	MCD4004 NSF	.72	1.85	
1/8" ID	3.2mm ID	18800	MCD4202 NSF	.72	1.75	
1/4" OD, .17" ID	6.4mm OD, 4.3mm ID	19100	MC2004 NSF	.58	1.15	
1/4" OD, .17" ID	6.4mm OD, 4.3mm ID	19200	MCD2004 NSF	.58	1.55	
1/8" ID	3.2mm ID	19400	MCD2202 NSF	.58	1.05/1.65	
1/4" ID	6.4mm ID	19600	MCD2204 NSF	.58	1.25/1.67	
1/8" ID	3.2mm ID	19900	MC2302 NSF	.62	1.18	.76
1/4" ID	6.4mm ID	15100	MCD2304 NSF	.63	1.28	.76

All measurements are in inches (millimeters) unless otherwise noted. Tubing must meet stated inside and outside diameters. †Note: CPC's Ferruleless PTF (polytube fitting) terminations do not require ferrules to achieve a secure connection and are therefore easier to use and reuse. PTF fittings are designed for semi-rigid tubing, i.e., polyethylene, nylon, polyurethane, etc.